

FISHER 37

NEIL MARINE



BUILDER : NEIL FERNANDO & CO. (PVT) LTD

Head Office:

No. 11, Alexandra Road, Colombo 6,
Sri Lanka

Phone: +94-11-2556891 – 894

Fax: +94-11-2580756

E-mail: contact@neilmarine.com

Web site: www.neilmarine.com

Boat Yard :

70A, St. Jude place,
Thaladuwa, Negombo

Sri Lanka

Phone : +94 – 31 – 2230901 – 905

Fax : +94 – 31 – 2238307

TECHNICAL SPECIFICATION FOR STANDARD VESSEL
 SPECIFICATION NO: NMF37/SB/SP/19/1341



FISHER 37 - SLOOP		
DIMENSIONS		
Length overall	12.96m	42ft 6 ins
Length over hull	11.31m	37ft 0 ins
Length waterline	9.91 m	32ft 6 ins
Beam	3.66 m	12ft 0 ins
Draft	1.60 m	5ft 3 ins
Displacement	14,224kgs	14 tons
Ballast Weight	6096kgs	6 tons
SAIL AREAS		
Main	28.40sqm	306 sqft
Furling Genoa	41.15sqm	443 sqft

FISHER 37 - KETCH		
DIMENSIONS		
Length overall	12.96m	42ft 6 ins
Length over hull	11.31m	37ft 0 ins
Length waterline	9.91 m	32ft 6 ins
Beam	3.66 m	12ft 0 ins
Draft	1.60 m	5ft 3 ins
Displacement	14,224kgs	14tons
Ballast Weight	6096kgs	6tons
SAIL AREAS		
Main	24.62sqm	265 sqft
Furling Genoa	12.63sqm	136 sqft
Mizzen	41.15sqm	443 sqft

1. CONSTRUCTION

- 1.1. The hull is of heavy duty hand laid GRP. The underwater section is finished in clear gel coat. Approximately 6 tons of cast iron ballast is encapsulated inside the GRP keel and glassed over with further laminates to form an integral part of the hull structure. The transverse structural bulkheads, of marine specification plywood are bonded to the hull. Heavy double skin GRP bulwarks, incorporating the hull to deck joint, are moulded as an integral part of the deck and capped with 25mm thick teak.
- 1.2. A teak rubbing strake and teak bulwark cladding is fitted. The deck is of heavy duty hand laid GRP moulding. Balsa stiffening is incorporated in all horizontal areas with plywood in fills in way of the deck fittings. Heavily stressed areas are additionally reinforced with unidirectional glass reinforcement. The deck is bonded to the hull and bolted throughout the whole hull to deck joint. The bulkheads are laminated to the deck resulting in a strong and integrated unit.

2. ENGINE

- 2.1. BETA engine model BETA 105 of 98HP - 4 cylinder, turbocharged diesel propulsion engine developing 98hp (Recreational Craft Directive emission compliant). The engine is supplied complete with a heat exchanger and header tank, exhaust manifold, fresh and sea water pumps, injection bend, mechanical fuel lift pump, fuel and oil filters, sump pump, flywheel housing, special quiet air intake filter, 12 volt starter, 70 amp battery charging alternator, shutdown solenoid, The engine is mounted on rubber anti-vibration mounts and secured to glass fibre, steel reinforced, engine beds moulded to the hull. The ABV control panel has a tachometer, water temperature gauge, oil pressure gauge and voltmeter. An audible alarm is fitted. A bronze stern tube with water lubricated cutlass bearing carries a stainless steel shaft driving a 3bladed bronze propeller. A zinc sacrificial anode is fitted to reduce stern gear corrosion. The engine is accessed via traps in the wheelhouse floor and through the door from the toilet compartment. The engine compartment is sound proofed.

3. STEERING GEAR

- 3.1. A hydraulic steering system consisting of pump and cylinder drives the rudder stock from the teak steering wheel in the wheelhouse. Emergency steering by tiller in cockpit. The rudder stock is stainless steel and is connected to the rudder.

4. TANKS

- 4.1. Diesel fuel: A single stainless steel tank complete with baffles of approximately 454 liters (100 gallons) is installed below the cockpit sole. An electric fuel content gauge is fitted in the instrument panel. The filler point is located on the side deck and the tank is vented overboard.
- 4.2. Fresh water: Two GRP baffled tanks of approximately 454 liters (100gallons) total are installed below the forward cabin sole and main saloon sole with fillers on the side decks.
- 4.3. Hot water: is supplied from a calorifier unit heated via the engine and pumped with a pressure pump to the galley, toilet and aft cabin.

5. BILGE PUMPS

- 5.1. A high capacity manual bilge pump is provided in the aft cockpit locker. An electric pump with manual and automatic switches on the console is fitted in the grey water tank fitted under the cabin sole.

6. ELECTRICS

- 6.1. Two banks of two 12v batteries supplying a total of approx. 400 amp/hr are fitted with isolator switches; one bank is for engine starting and the other for domestic systems. Charging is via the engine driven alternator.
- 6.2. Cabin LED lighting is provided throughout the accommodation including a chart light at the chart table. Standard navigation lights are fitted with port and starboard lights in teak shield boxes mounted on the wheelhouse roof.
- 6.3. The wiring loom is colour coded and all circuits are fully protected and controlled by circuit breakers on the main panel.

7. UNDERWATER FITTINGS

- 7.1. All underwater fittings except the propeller shaft and rudder stocks are bronze. Through hull skin fittings are kept to a minimum by draining all wastewater to a central small grey water sump from where it is pumped overboard by the electric bilge pump.



8. DECK FITTINGS

The following are fitted:-

- 8.1. Stainless steel pulpit and stanchions with plastic sheathed lifelines. Lifeline gates with pelican hooks and adjustable bottle screws, to port and starboard. Stainless steel bowsprit with teak slatted platform available at additional cost.
- 8.2. Forestay and genoa attachment points and double anchor roller with anchor stowage.
- 8.3. Two large mooring cleats on foredeck with fairleads, two mid-ship cleats and two large bollards aft.
- 8.4. Chafing plates fitted to the teak rail capping in way of the fairleads.
- 8.5. Through-bolted headsail tracks on coamings. Self-tacking track for staysail.
- 8.6. Self-tailing winches for genoa on cockpit coamings.
- 8.7. 45lbs SPADE anchor with 50 meters 8mm calibrated chain.
- 8.8. Electric anchor windlass. Teak fore and aft handrails on wheelhouse roof.
- 8.9. All working areas deck covered are with Ceylon Teak.
- 8.10. Teak fore and aft handrails on the wheelhouse roof. Two vents and three ventilators on the coach roof. Diesel and water tank fillers in deck.

9. SPARS

- 9.1. The sloop version and ketch rig versions are available. The mast and boom are silver anodized aluminium alloy with stainless steel and alloy fittings.
- 9.2. The following are fitted: Steaming light. Combined anchor light.

10. RIGGING

- 10.1. 10.1 Rigging is heavy duty 1 x 19 stainless steel wire with stainless steel rigging screws. The running rigging is of pre-stretched Terylene.
- 10.2. 10.2 The following are supplied: main, genoa (staysail and mizzen for ketch rig) halyards and sheets, boom topping lift, burgee and signal halyards.
- 10.3. 10.3 Genoa reefing system is supplied (optional).

11. SAILS

- 11.1 For sloop: Mainsail and furling genoa in white Terylene cloth. The main is equipped with slab reefing, foot outhaul and leech tension. Sail cover for mainsail. The genoa is fitted with luff tape to suit the roller furling system and a UV protection strip.
- 11.2 For ketch: Mainsail, mizzen and furling genoa in white Terylene cloth. The main is equipped with slab reefing, foot outhaul and leech tension. Sail covers form a in sail and mizzen. The genoa and staysail are fitted with luff tape to suit the roller furling systems and a UV protection strip.

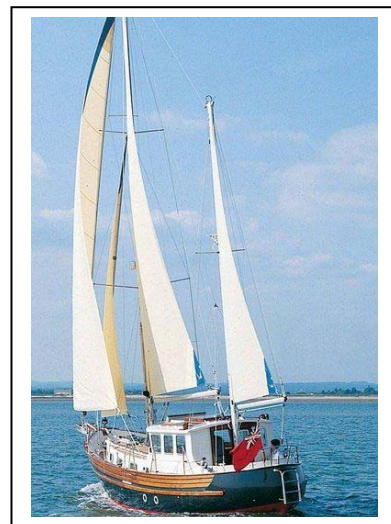

12. WINDOWS, PORTLIGHTS AND DOORS

- 12.1. All window frames and port lights are anodized aluminium alloy glazed with toughened glass. The wheelhouse/deck saloon has 3 slide opening windows, one each side, and one aft. The center forward wheelhouse window is equipped with a screen wiper and also has a drop down section for ventilation. There are opening windows in the coach roof for the fore cabin, saloon and toilet compartment and fixed hull ports in the forward and aft sleeping cabins. A double door with lock is fitted in the aft end of the wheelhouse (sliding door for ketch rig option).

13. INTERIOR JOINERY & COVERINGS JOINERY

- 13.1. All the interior joinery is solid Ceylon teak and teak veneered plywood.
- 13.2. Galley and toilet compartment worktop surface offered in granite. Alternative countertop can be offered at additional cost.

14. LININGS

- 14.1. The overhead linings are of vinyl upholstered plywood or GRP panels, detachable for access, teak battens separate the panels. The hull sides and hanging lockers are lined with foam backed vinyl or carpet to help prevent condensation.

15. COVERINGS

15.1 All cushions are upholstered in colour co-ordinated fire retardant fabrics. Teak parquet floor is fitted on all cabin soles and wheelhouse sole.

16. ACCOMMODATION

16.1. FORECABIN

16.1.1 There are two full length single berths with a double berth infill with storage lockers beneath. The chain locker is forward of the berths with an access trap fitted in the bulkhead. One opening port on each side of the coach roof. 2 berth lights on the bulkhead plus an overhead light. Paneled door to saloon. Ventilator to deck. Opening skylight hatch. Two small shelves at the head of each berth. There are two lockers aft of each berth, one is a hanging locker, the other has shelves for storage.

16.2. TOILET (AFT AND TO STARBOARD)

16.2.1. The separate toilet compartment is to port with a large bowl marine toilet and wash basin. The work surface in granite. Hot and cold water is supplied from the pressure pump. There is a shower operating from the mixer taps and a shower tray with a teak grating over which drains into the bilge sump. The following are also fitted: A locker outboard has shelves and slide opening Perspex doors. Fixed overhead light. Mirror over wash basin. Cup holder. Concealed toilet roll holder. One opening coach roof window. There is access from the toilet compartment to the engine room space via a sound proofed door.

16.3. SALOON

16.3.1. An 'L' shaped settee is to port with lockers and stowage outboard under the side deck. The settee can be used as a berth. There is stowage below with drawers and behind the settee back. The saloon table can extend aft. Overhead and reading lights are provided there are teak curtain pelmets and grab rails outboard. There are two opening windows in the coach roof and a ventilation hatch over.



16.3.2. GALLEY

The galley is to starboard in the saloon. It is fitted with: A 2 burner cooker with grill and fail-safe on all burners. Stainless steel sinks (one half size) supplied with pressurized hot and cold water from the pressure pump. Cupboards behind and outboard of the worktop which are fitted with smoked Perspex fronted sliding doors. Plate and cup storage. Drawers and lockers for food storage. Overhead vent. Overhead lights. Two opening windows and an opening hatch over. Granite work surfaces. Teak fiddle rails. Gas shut off valve adjacent to cooker.

16.4. QUARTER CABIN

16.4.1. There is a cabin to port with a double berth. The following are fitted: General clothes storage locker with shelves. Hanging locker. Overhead light and berth reading light. One opening window and an opening port to the wheelhouse. Ventilator to deck. Mirror on the aft forward facing bulkhead.

16.5. WHEELHOUSE

16.5.1. The central steering position with main instrument console is in the wheelhouse with a helmsman's seat. There is a settee to port with a chart working space forward and a full length settee to starboard with a deep stowage locker under the starboard side aft. The wheelhouse table folds down to stow against the aft bulkhead. Stowage lockers are built into the forward end of the wheelhouse console under the chart working space. Chart storage is provided under the port settee. Anodized aluminium profile sliding hatch with smoke colour 10 mm acrylic pane fitted over wheel house roof.

The specification is believed to be correct at the time of printing but the Builder reserves the right to make alterations without notice. Such alterations will not be considered applicable to yachts delivered.

Construction contracts and terms of business are available for inspection on request



16.6. COCKPIT

16.6.1. The cockpit is an integral part of the GRP deck moulding. It is self draining through two 38 mm bore drains with valves at the hull. Hinged lockers are fitted in the seat tops to give access to the stowage lockers and the steering gear beneath. The gas locker is fitted in the cockpit coaming and is vented overboard. A slatted teak flooring is fitted on the sole.

17. OUTLINE INVENTORY

17.1. In addition to items mentioned in the specification the yacht will be complete with the following:-1 x Compass, 1 x Gas bottle, 2 x Mooring warps, 1 x Kedge anchor and warp, 4 x Fenders, 1 x Ensign staff and holder, 3 x Fire extinguishers, 1 x Fire blanket, 1 x Boat hook

18. OPTION

- 18.1. Black Water Tank with System
- 18.2. Pressurized hot water with immersion heater and Calorifier
- 18.3. External shower
- 18.4. Webasto heating system
- 18.5. Battery charger 12V,80A
- 18.6. Shore power 110/220V
- 18.7. Bow Thruster 75KGF
- 18.8. Electric windlass
- 18.9. Replace CQR 20kg anchor with SPADE 20 kg anchor
- 18.10. VETUS Sliding sunroof over wheel house
- 18.11. Fixing Diesel hob instead of the Gas hob
- 18.12. Clock and Barometer with brass cover
- 18.13. Rope cutter on shaft
- 18.14. Genoa Furling system

Note : builder reserves the right to amend the specification at any given time.

FISHER 37 KETCH RIG



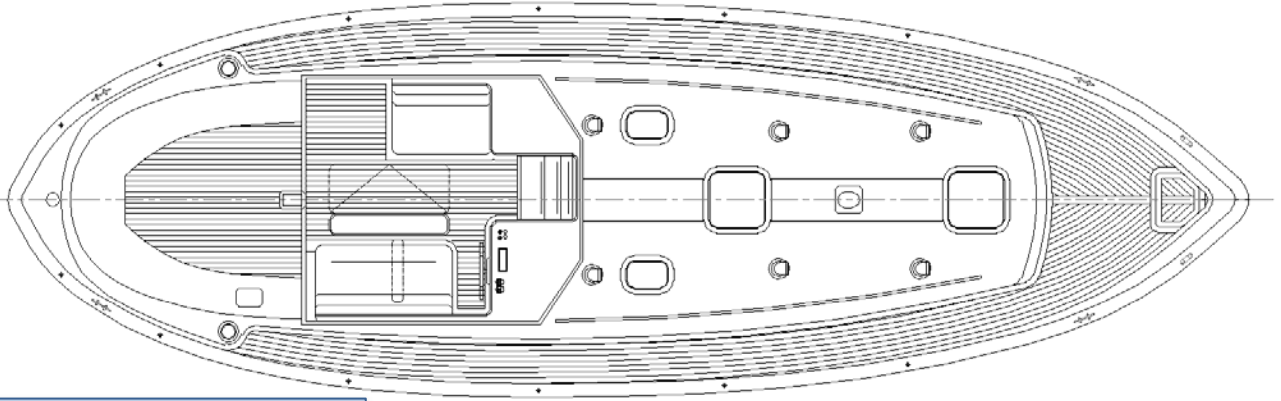
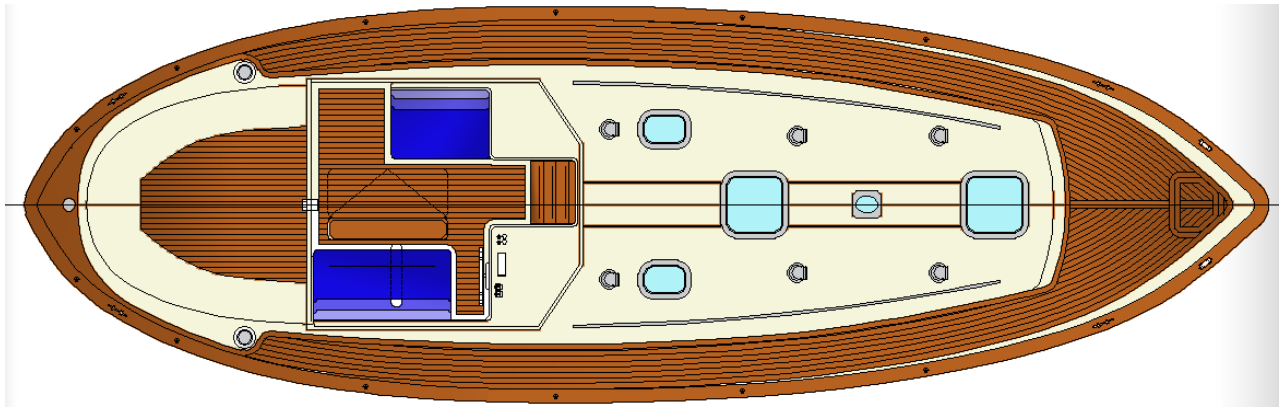

DECK PLAN

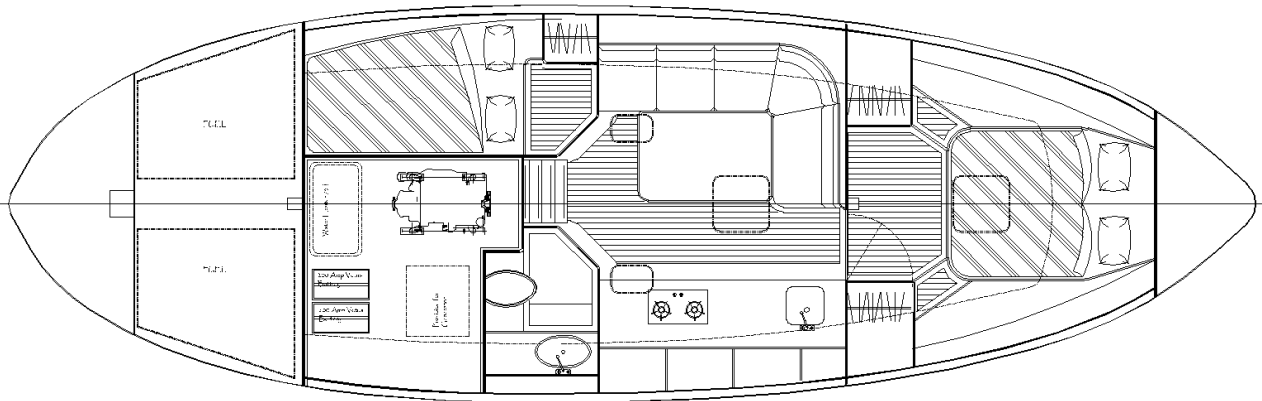
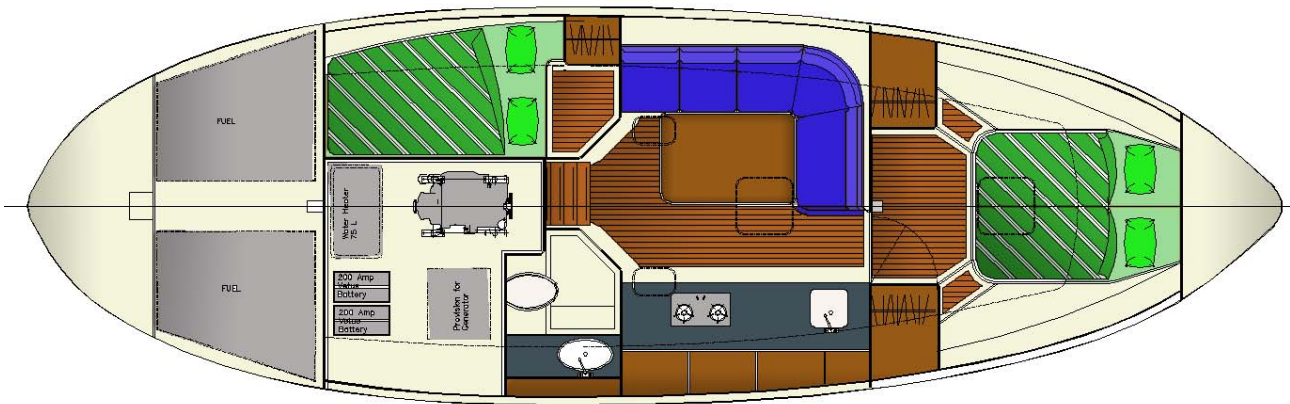

INTERIOR LAY OUT

FISHER 37 SLOOP RIG



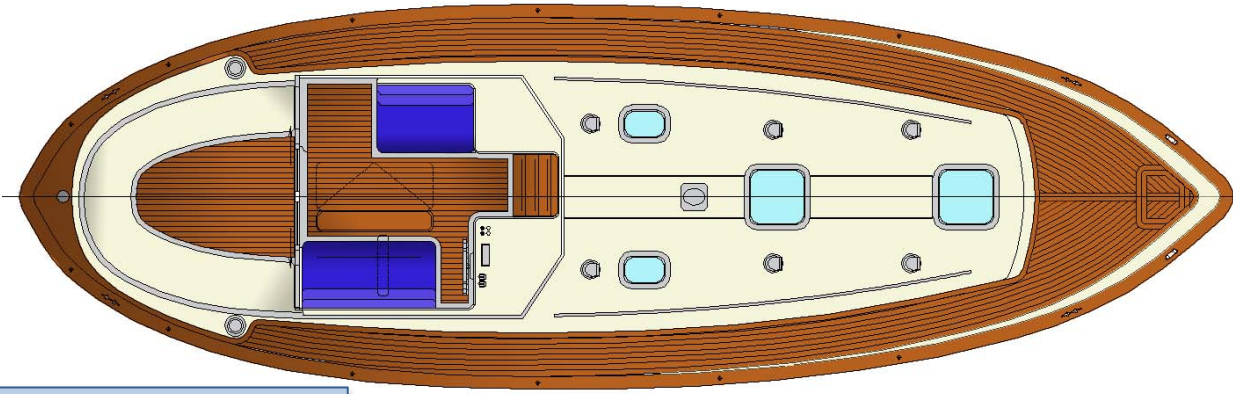

DECK PLAN

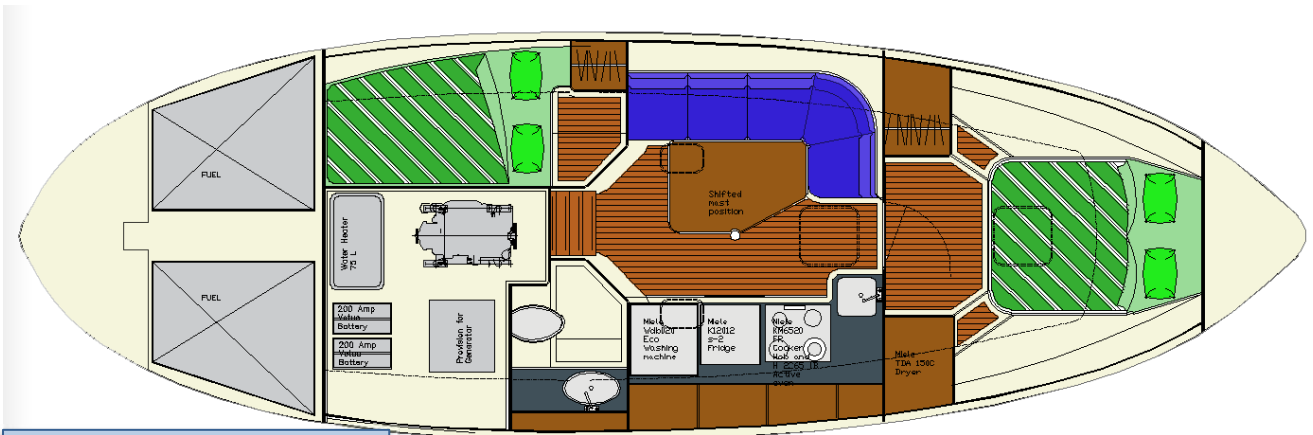
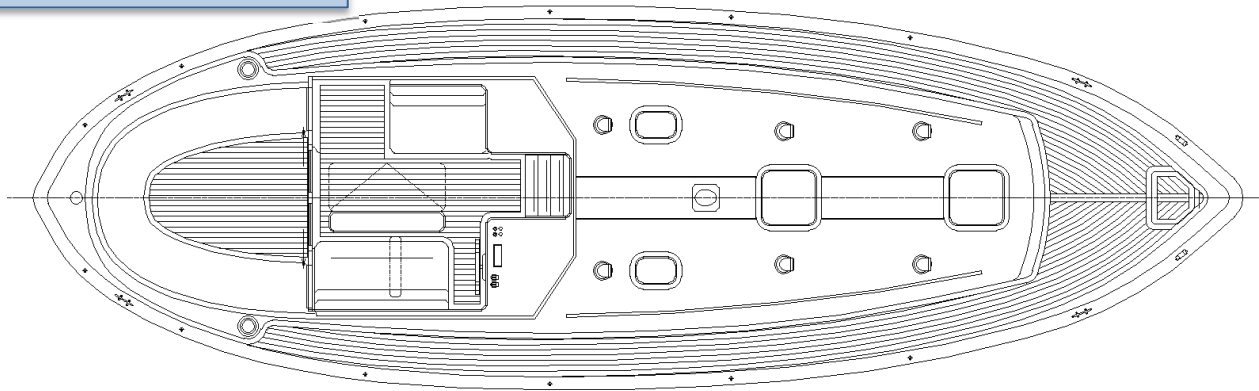

INTERIOR LAY OUT

